

ASCENDA

by Cibăș | symmetry



CUTTING EDGE TECHNOLOGY

THE ASCENDA



WIRELESS REMOTES



INNOVATIVE HATCH SYSTEM

When the elevator descends to the lower stop, a hatch slides into your upper floor to cover the hole and allow you to walk around your space freely with no risk.

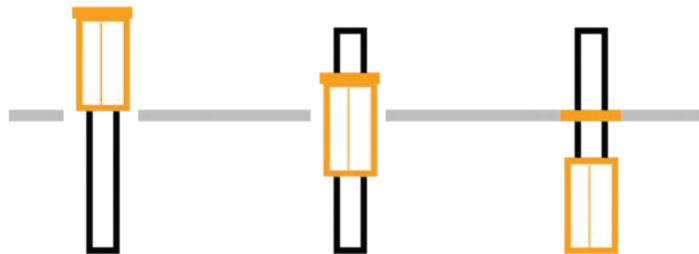

HANDRAIL CONTROL & BUILT-IN SEAT

Travel in full comfort by just resting your hand on the handrail to activate the elevator. Pop down the seat to rest while you travel between floors!

FULLY ENCLOSED CABIN

Our beautiful glass saloon doors are power operated and will retract if contacted while opening or closing and safely enclose the passenger during travel.

TOP & BOTTOM SAFETY PAN

Should anything come above or beneath the elevator as it travels, the moment it touches the safety plate, the elevator will automatically stop.

ECOSILENT SCREW DRIVE SYSTEM

Our fully enclosed glass tower will fit wonderfully inside any home. It holds our EcoSilent screw-drive technology, which runs with minimal electrical consumption.

EMERGENCY BATTERY LOWERING

In case of a power outage, the elevator will enter emergency battery operation, allowing you to lower the elevator to the bottom floor and open the doors.

MANUAL LOWERING SYSTEM (MLS)

We prioritize redundant safety features, and this one is no exception. In any situation, you can always lower the cabin manually using our MLS in an emergency.

ABOUT ASCENDA

The Ascenda was created by the Cibes Lift Group with a simple mission: to provide accessibility to two-story homes at the highest safety standards.

The Ascenda not only conforms with both European and American safety standards, it also comes packed with safety features such

as redundant obstruction sensors and an emergency stop button.

But it doesn't stop there. When it comes to your home, looks matter, and our all glass (ANSI stamped laminated safety glass) design will fit right in. Whether you want it invisible in a corner or as a centerpiece, an Ascenda will always look fantastic!



A TRUSTED BRAND A GLOBAL NETWORK

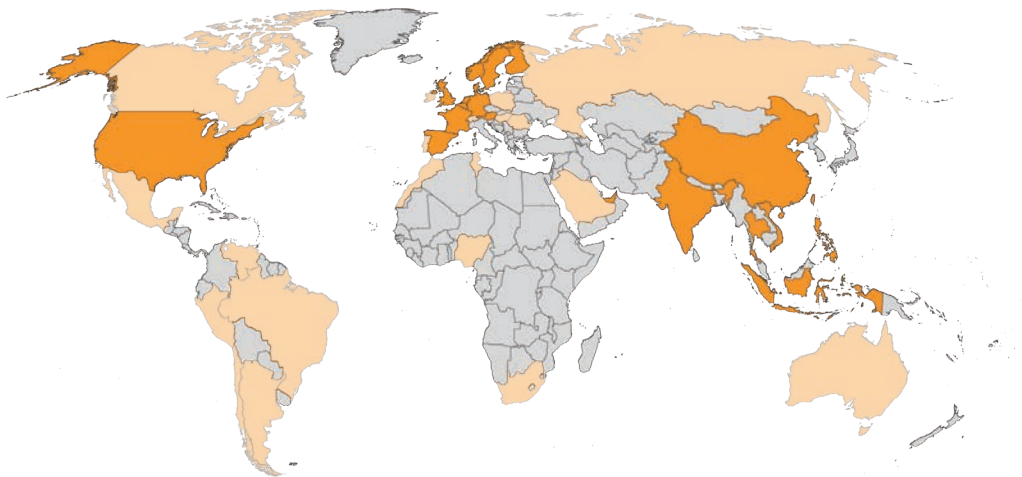

70+
COUNTRIES

150+
AUTHORISED
PARTNERS

THE NEW STANDARD **FULLY LOADED**

At Cibes Symmetry, we are dedicated to crafting the finest elevators possible. That means our standard offering comes fully equipped with all the stops, bells, whistles, and more. Explore some of the key features included in your Ascenda.



AUTOMATIC SALOON DOORS

Fully automatic as standard, for a far more premium feel.



MIRROR CEILING WITH BUILT-IN FAN

Our mirrored ceiling isn't just beautiful - it also holds a fan to provide ventilation.



FOLD DOWN SEAT

Essential features should always be included - and that's why our fold down seat (330 lb capacity) is standard.*

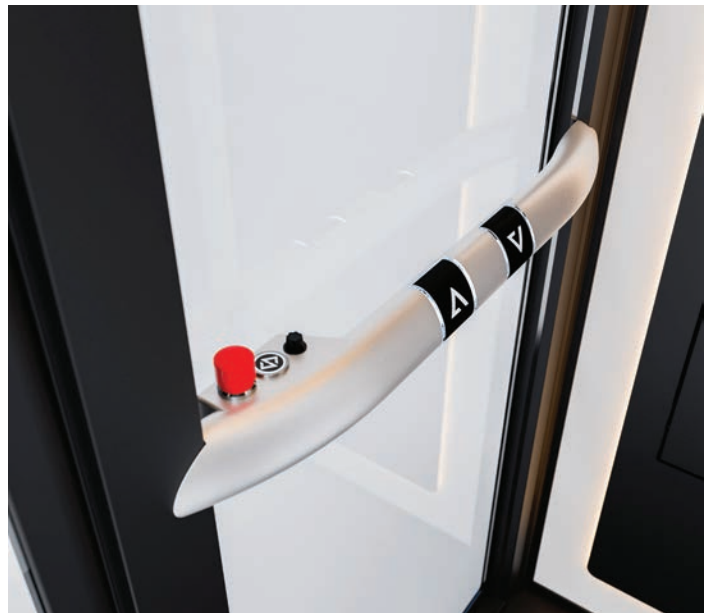

INTUITIVE HANDRAIL CONTROL

Hold to run control buttons are built into the handrail as standard feature.*

FULLY LOADED

ALL GLASS

Our mast and cabin both come in all laminated safety glass as standard. Not only will it better fit in to your home design, but you get to enjoy the view on the way up!

LIGHTING

Our guiderail lighting not only looks fantastic (wait until you use your elevator at night). It also serves as a soft warning light that someone is about to come up or down.



PERFECT FOR HOLD TO RUN INTUITIVE DUAL CONTROL

Each Ascenda comes with dual control panels: one vertical and in a classic position, and the other built into the handrail itself. This allows passengers to control the elevator with ease, no matter which direction they choose to travel.



STANDING / TRADITIONAL COP

Just press the button on the main car operation panel (COP) to move the elevator up and down, like you would on any other elevator!



STANDING / HANDRAIL CONTROL

A much more comfortable way to travel: rest your hand on the UP or DOWN button and let the elevator take you to your chosen destination!

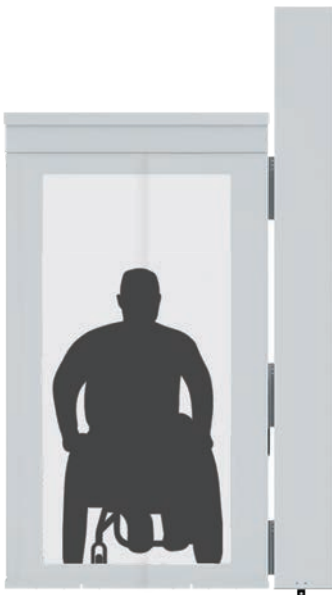

WHEELCHAIR / HANDRAIL CONTROL

The perfect solution for wheelchair users, as the handrail control is always within easy reach and is incredibly intuitive to use!

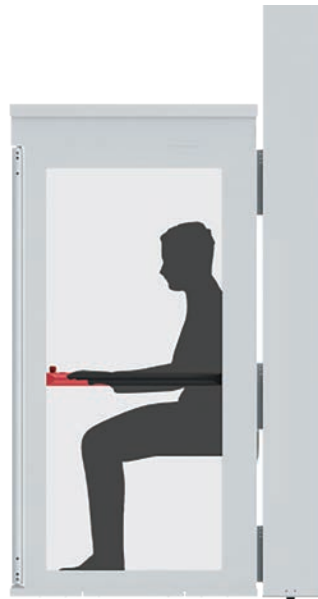

SITTING / HANDRAIL CONTROL

The fold down seat is immensely practical, but not if you have to use traditional controls at the same time! That's where the handrail control comes in handy!

THERE'S AN
APP
FOR THAT!



AN ESSENTIAL SAFETY FEATURE **THE ASCENDA APP**

- ▶ Monitor the elevator remotely and receive notifications in case of errors
- ▶ Call into the elevator's phone through the application to check on the passengers
- ▶ Check your elevator's info including Serial # and Maintenance
- ▶ Call your local Ascenda hotline through the application without having to look for the number

...and more!



HATCH OR GATE

INSTALLATION METHODS



Through the floor application with hatch



Mezzanine application with half landing gate

OUR COMMITMENT SAFETY FIRST

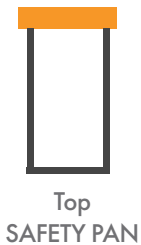

Top
SAFETY PAN



Bottom
SAFETY PAN



Emergency
STOP BUTTON



Top Floor
SAFETY HATCH



Overspeed
MAX LIMIT



Final
LIMIT SWITCH



Emergency
PHONE

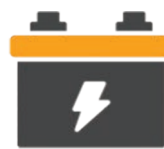

For Power Outages
BATTERY LOWERING
OPERATION



Weight
LIMIT SENSOR

ABOUT ASCENDA

FAQ

WHAT IS THE ASCENDA?

The Ascenda is a shaftless elevator designed for two story homes. It is extremely space-saving, incredibly safe and comes fully-loaded with standard features such as automatic saloon doors, a fold down seat and dual control for intuitive Hold to Run operation.

HOW DOES AN ASCENDA RUN?

The Ascenda is a screw-driven elevator, meaning it is always attached to a toughened steel screw via a nut. As the nut rotates, it moves the elevator cabin up or down. This technology has the advantage of requiring no pit and no machine room while being both extremely silent and space-saving.

HOW MUCH SPACE IS REQUIRED?

You can find all our sizes on the next page. Our smallest Ascenda requires less than 10 square feet!

WHERE CAN I INSTALL AN ASCENDA?

The Ascenda can be installed in virtually any part of your home! Whether it's through the floor or connecting to a mezzanine level, its versatile design allows for seamless integration against a wall or wherever you need it. The Ascenda offers unmatched flexibility to fit your space.

CAN I USE THE ASCENDA AT NIGHT?

The Ascenda is designed for use 24 hours a day, 7 days a week. At night, it is illuminated inside the cabin by the spotlights in the mirror ceiling. Additionally, it features lights that run the full length of the mast, illuminating the arrival area which both warns other house members of the elevator's arrival, and provides lighting when exiting the elevator.

WHAT HAPPENS IN CASE OF A POWER OUTAGE?

The Ascenda will switch to battery lowering operation. By pressing any button, the battery will bring the elevator to the lower landing, at which point the doors will open to let the passenger safely exit.

IS ASCENDA WHEELCHAIR FRIENDLY?

The L and XL sizes are both wheelchair friendly. The L size is perfect for more compact wheelchairs, while the XL can fit almost any wheelchair.

But it doesn't stop there - thanks to its handrail control, wheelchair users will find that moving up and down in an Ascenda is easy and intuitive as the buttons are extremely accessible.

DOES IT HAVE TO BE HOLD TO RUN?

According to both American and European standards, shaftless elevators must operate in "Hold to Run" mode to ensure safety.

However, thanks to the innovative handrail control, our customers are surprised to find it so easy to control that they barely notice it!

WHAT DOES "FULLY LOADED" MEAN?

In the home elevator industry, the traditional business model is to offer a basic, ultra-standard elevator and then charge significantly for any additional options.

At Cibes Symmetry, we believe that every home deserves the best possible elevator, and that is why we offer our key features as standard. Full glass mast? Included. Automatic saloon doors? Included. Dual control? Included.

IS AN ASCENDA SAFE?

The Ascenda is designed to meet both European and USA safety standards (ASME 17.1 Section 5.3). It also comes packed with safety features such as safety sensors below and above the cabin and in the hatch, along with an emergency stop button, two-way phone with app-linked notifications in case of faults, battery lowering operation and more!

IS THERE A WARRANTY?

Yes, the Ascenda includes a 2-year manufacturer's parts warranty.

WHAT ARE THE POWER REQUIREMENTS?

An Ascenda can operate on a 208/230V, single phase power system within your home.

WHAT ABOUT CONSTRUCTION?

The construction work required is minimal and your installing dealer will guide you through the process.

WHAT ABOUT ANCHORING POINTS?

We anchor the Ascenda in three points: on the ground, on the slab or floor beams, and at the top. You can always ask your Ascenda Certified Distributor for more details as, even in tough situations, we have flexible solutions such as extending guiderails.

CAN IT BE INSTALLED OUTDOOR?

Unfortunately, the Ascenda is not yet available for outdoor usage, and is limited to indoor installations.

WHAT HAPPENS IF SOMEONE IS STANDING ON THE HATCH AS THE ASCENDA IS COMING UP? WHAT ABOUT IF SOMEONE IS BELOW AS IT IS COMING DOWN?

This is where all the Ascenda's safety systems come into play. If anything above 20 lbs. is on the hatch, the Ascenda will stop, and will only be able to move downwards (to the ground floor) until the object or person is removed from the hatch.

Similarly, if the Ascenda is going downward and the lower safety pan comes into contact with a person or object, the elevator will automatically stop and will only be able to move upwards until the obstruction is cleared.

HOW MUCH FINISHED FLOORING CAN BE ADDED TO THE HATCH?

11 lbs can be added to the Ascenda hatch.

TECHNICAL SPECIFICATIONS

A PERFECT SIZE...

S
Size



AVAILABLE IN:



White (standard)



Black (optional)
(Longer lead time)

CAN FIT:



M
Size



AVAILABLE IN:



White (standard)



Black (optional)
(Longer lead time)

CAN FIT:



STANDING SPACE	27 1/2" x 23 3/4"	STANDING SPACE	27 1/2" x 31 1/2"
FINISHED CABIN SIZE	32 1/4" x 41 3/4"	FINISHED CABIN SIZE	32 1/4" x 49 5/8"
HATCH CUT-OUT *	36 3/4" x 44 9/16"	HATCH CUT-OUT *	36 3/4" x 52 1/2"
CLEAR DOOR OPEN	27 1/2"	CLEAR DOOR OPEN	27 1/2"

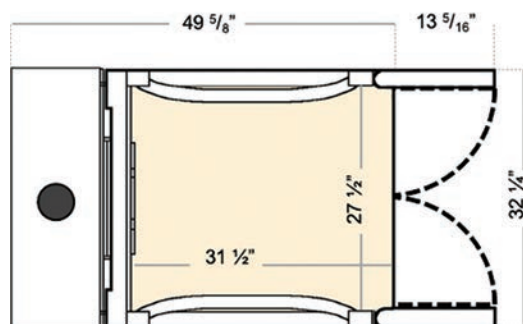
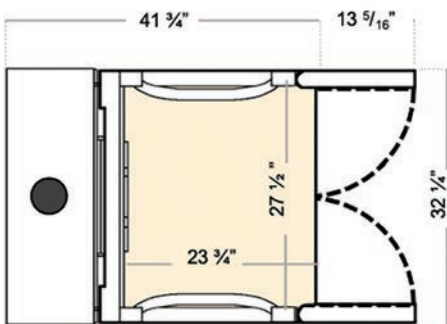

TECHNICAL SPECIFICATIONS

Drive	Screw-Drive	Door Type	Fully Automatic Saloon
Screw Type	Trapezoidal, 24 mm	Maximum Load	770 lbs
Drive Type	EcoSilent 2.0	Maximum Speed	30 feet / minute
Motor	PMSM Ultra Quiet	Operation	Hold to Run/ Constant Pressure
Motor Power	2.9 kW / 3.8 HP	Glass Type	ANSI Stamped Laminated Safety Glass
Landing Call Stations	2 Wireless Remotes	Maintenance	1 x per year
Lighting Type	Automatic EcoSaving LED	Pit	0"

*Civil Works should only be done once approved by our qualified technicians.

TECHNICAL SPECIFICATIONS ...FOR EVERY NEED

L
Size



AVAILABLE IN:



White (standard)



Black (optional)
(longer lead time)

CAN FIT:



XL
Size



AVAILABLE IN:



White (standard)



Black (optional)
(longer lead time)

CAN FIT:



STANDING SPACE	27 1/2" x 39 1/2"	STANDING SPACE	33 1/2" x 49 1/4"
FINISHED CABIN SIZE	32 1/4" x 57 1/2"	FINISHED CABIN SIZE	51 3/16" x 54 7/16"
HATCH CUT-OUT *	36 3/4" x 60 5/16"	HATCH CUT-OUT *	54 1/2" x 59"
CLEAR DOOR OPEN	27 1/2"	CLEAR DOOR OPEN	32 1/2"

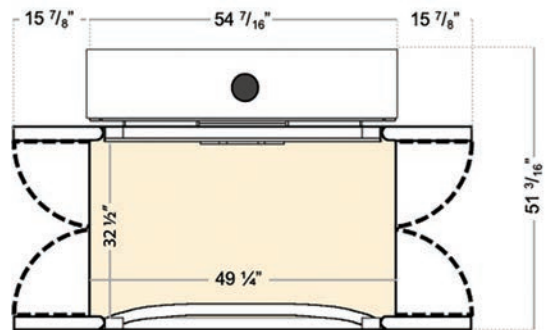
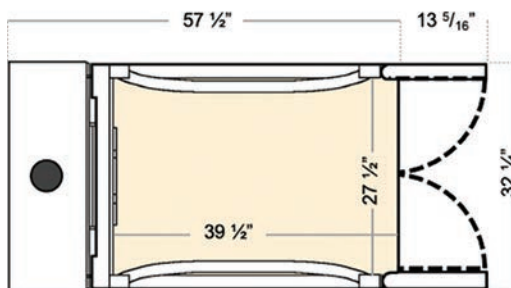

TECHNICAL SPECIFICATIONS

Power Supply	Main Line: 230V, 60 Hz, Single Phase, 30 Amp Car Light: 115V, 60 Hz, Single Phase, 15 Amp Machine Space Lighting: 115V, 60Hz, Single Phase, 15 Amp Machine Space Receptacle: 115V, 60Hz, Single Phase, 15 Amp
1st Landing Height	88 3/4"
2nd Landing Height	89"
Minimum Operating Clearance	1"
Maximum Travel	14'
Anchor Points	Ground, Slab/Beam, Top
Emergency Power System	Emergency Battery Lowering Operation
Manual Lowering Access	At Bottom of Mast

HALF LANDING GATE

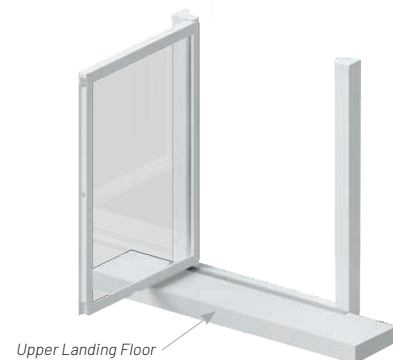

ASCENDA

by Cibės | symmeTRY



877-375-1428



customerservice@cibessymmetry.com

